



Distributor

Oil Solutions

Phone 0421 336 009

Fax 03 9012 4332

International

Phone 61 421 336 009

Fax 61 3 9012 4332

sales@oilsolutions.com.au

www.oilsolutions.com.au

PO Box 653 Castlemaine Australia 3450

ACCUMULATORS

Bottom Repairable - Medium Pressure 210 Bar

AC SERIES

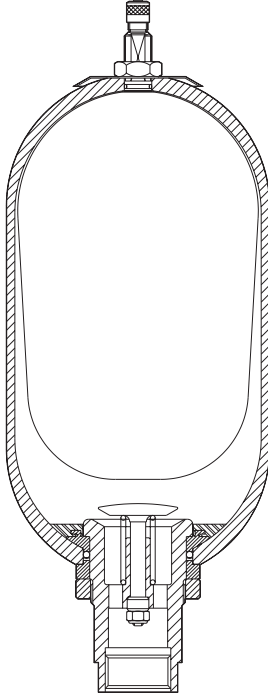

- Fully repairable industrial bladder accumulator
- Design, control & manufacture in accordance with AS.1210-1FH and BS.7201-1989
- Internal epoxy low friction shell lining on all water service accumulators. Optional halar lining available for chemical service applications (up to 20 litre)
- High pressure 1/4"BSPP coreless gas valve supplied standard.(Other connections available upon request)
- Standard nitrile rubber high strength bladder with optional stainless steel stem available upon request

OIL SERVICE

part number	gas vol. (litres)	pressure rating (bar)	connection	length/diam. (mm)
			00 (NBR 25) 3S (HNBR 30)	
** ↓ AC10**A-00-21A	9.4	210	BSP 2"	570,Ø228
AC20**A-00-21A	18.8	210	BSP 2"	886,Ø228
AC25**A-00-21A	24.5	210	BSP 2"	1158,Ø228
AC37**A-00-21A	35.2	210	BSP 2"	1425,Ø228
AC50**A-00-21A	49.2	210	BSP 2"	1930,Ø228
1½" SAE			split flange code 62	

WATER SERVICE

part number	gas vol. (litres)	pressure rating (bar)	connection	length/diam. (mm)
			00 (NBR25) 3S (HNBR30) AS (EPDM) 6S(FPM)	
** ↓ AC10**A-02-21A	9.4	210	BSP 2"	570,Ø228
AC20**A-02-21A	18.8	210	BSP 2"	886,Ø228
AC25**A-02-21A	24.5	210	BSP 2"	1158,Ø228
AC37**A-02-21A	35.2	210	BSP 2"	1425,Ø228
AC50**A-02-21A	49.2	210	BSP 2"	1930,Ø228

Bottom Repairable - High Pressure 345 Bar

AC SERIES

- Fully repairable industrial bladder accumulator
- Design, control and manufacture in accordance with AS.1210-1FH
- Internal epoxy low friction shell lining on all water service accumulators. Optional halar lining available for chemical service applications (up to 20 litre).
- High pressure gas valve core with standard 1/4"BSPP charging connection on smaller units. High pressure coreless gas valve supplied standard on 4 to 50 litre units. (Other connections available upon request)
- Standard nitrile rubber high strength bladder with optional stainless steel stem available upon request.

OIL SERVICE

part number	gas vol. (litres)	pressure rating (bar)	connection	length/diam. (mm)
**			00(NBR25) 3S(HNBR 30)	
0B**A-00-341	0.16	345	BSP3/4"	292,Ø56
0F**A-00-341	0.6	345	BSP3/4"	269,Ø90
011**A-00-40A	1.15	400	BSP3/4"	283±10,Ø118
025**A-00-40A	2.5	400	BSP3/4"	481±8,Ø118
04**A-00-34A	3.8	345	BSP1 1/4"	454±8,Ø165
AC10**A-00-34A	9.4	345	BSP2"	570,Ø228
AC20**A-00-34A	18.8	345	BSP2"	886,Ø228
AC37**A-00-34A	35.2	345	BSP2"	1425,Ø228
AC50**A-00-34A	49.2	345	BSP2"	1930,Ø228
1 1/2" SAE				split flange code 62

WATER SERVICE

part number	gas vol. (litres)	pressure rating (bar)	connection	length/diam. (mm)
**			00 (NBR25) 3S (HNBR30) AS (EPDM) 6S (FPM)	
011**A-02-40A	1.15	400	BSP3/4"	283±10,Ø118
025**A-02-40A	2.5	400	BSP3/4"	481±8,Ø118
04**A-02-34A	3.8	345	BSP1 1/4"	454±8,Ø165
AC10**A-02-34A	9.4	345	BSP2"	570,Ø228
AC20**A-02-34A	18.8	345	BSP2"	886,Ø228
AC37**A-02-34A	35.2	345	BSP2"	1425,Ø228
AC50**A-02-34A	49.2	345	BSP2"	1930,Ø228

Top Repairable - High Pressure 345 Bar

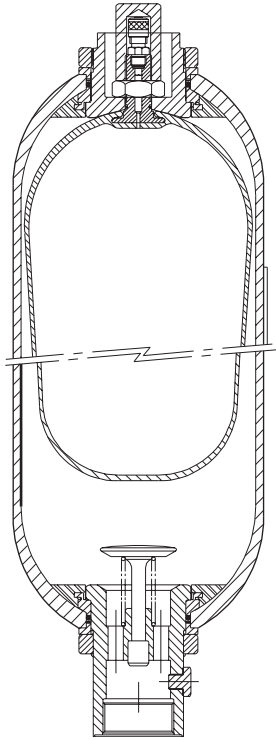

NG SERIES

- Fully top and bottom repairable bladder accumulator
- Hi-flow fluid port with standard 2"BSPP connection supplied on all oil service accumulators. Code 62 SAE 1 1/2 and code 61 SAE 2" fluid ports available upon request
- Design, control and manufacture in accordance with AS 1210-1FH
- High pressure coreless gas valve as standard 1/4"BSPP (other connections available upon request)
- Standard nitrile rubber high strength bladder with optional stainless steel stem available upon request
- Water service units are fitted with stainless steel fluid port and top plug and are using an internally lined shell.

OIL SERVICE

part number	gas vol. (litres)	pressure rating (bar)	connection	length/diam. (mm)
**			00 (NBR25) 3S (HNBR 30)	
NG10**A-00-34A	9.4	345	BSP2"	579,Ø228
NG20**A-00-34A	18.8	345	BSP2"	890, Ø228
NG37**A-00-34A	35.2	345	BSP2"	1411,Ø228
NG50**A-00-34A	49.2	345	BSP2"	1909, Ø228
NG57**A-00-34A	52.2	345	BSP2"	2001,Ø228
1 1/2" SAE			split flange code 62	

WATER SERVICE

part number	gas vol. (litres)	pressure rating (bar)	connection	length/diam. (mm)
**			00 (NBR25) 3S (HNBR 30) AS (EPDM) 6S (FPM)	
NG10**A-02-34A	9.4	345	BSP2"	579,Ø228
NG20**A-02-34A	18.8	345	BSP2"	890, Ø228
NG37**A-02-34A	35.2	345	BSP2"	1411,Ø228
NG50**A-02-34A	49.2	345	BSP2"	1909, Ø228

Large Volume Accumulators 350 Bar

LD OIL SERVICE SERIES

- Large diameter accumulators 35 to 65 litre
- Top and bottom repairable
- Bladder material : low permeability high nitrile
- Design, control and manufacture in accordance with AS 1210-1FH
- Water service version available with internal epoxy lining and stainless steel fittings

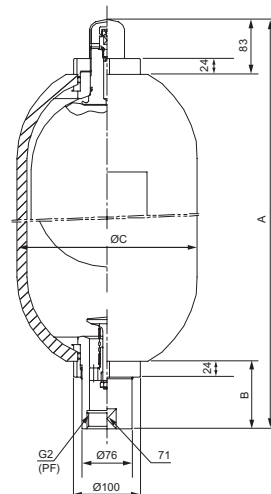

part number	pressure rating (bar)	gas vol. (litres)	weight (kg)	A	B	C	max. flow (L/min)
LD 3530A-10-35A	350	35	109	1104	102	273	1250
LD 4530A-10-35A	350	45	137	1324	102	273	1250
LD 5530A-10-35A	350	54	154	1544	102	273	1250
LD 6530A-10-35A	350	64	177	1764	102	273	1250

VLD OIL SERVICE SERIES

- Very large diameter accumulators
- Top and bottom repairable
- Compact alternate to accumulator banks
- Fitted with high or ultra high flow fluid ports
- Design, control and manufacture in accordance with AS 1210-1FH
- Water service version available with internal epoxy lining and stainless steel fittings
- Special models available for higher pressure ratings

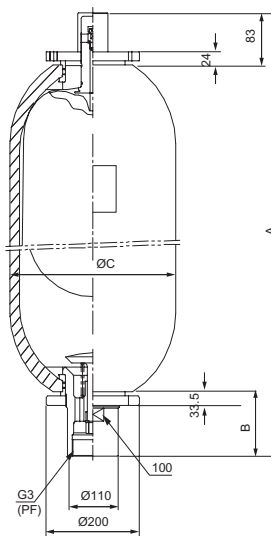

part number	pressure rating (bar)	gas vol. (litres)	weight (kg)	A	B	C	max. flow (L/min)
VLD 8030A-50-35A	350	78	224	1452	138	357	2260
VLD12530A-50-35A	350	127	375	2125	138	357	2260
VLD 15030A-50-35A	350	150	429	2435	138	357	2260
VLD 16030A-50-35A	350	160	415	2515	138	357	2260
VLD 8030A-60-35A	350	78	224	1482	168	357	4800
VLD 12530A-60-35A	350	127	375	2155	168	357	4800
VLD 15030A-60-35A	350	150	429	2465	168	357	4800
VLD 16030A-60-35A	350	160	415	2545	168	357	4800